

MOR Stage 1, South Rifle Bay

“Shoot and Scoot”

RULES: Practical Shooting Handbook, Latest Edition **COURSE DESIGNER:** Tom Chambers

START POSITION: Seated on X's, facing up-range. Loaded Rifle is leaning against Port C.

STAGE PROCEDURE

At audible start retrieve rifle engage targets as they become visible from the platform only.

SCORING

SCORING: Comstock, 9 rounds, 60 points
TARGETS: 6 IPSC, 3 Rifle Flasher Targets
SCORED HITS: Best 1 per IPSC, Hit Steel is 2A
START-STOP: Audible - Last shot
PENALTIES: Procedural. -10
 Miss. -10 per paper, -20 per steel

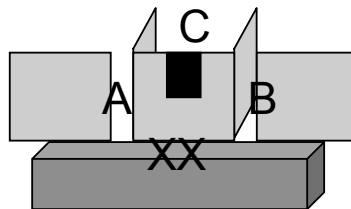
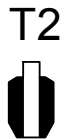

SETUP NOTES: Rifle Flasher Targets are approx. 200 yards. Paper between 30 and 50 yards

RO NOTES:

MOR Stage 2 North Rifle Bay, "Unstable Platform"

RULES: Practical Shooting Handbook, Latest Edition **COURSE DESIGNER:** Tom Chambers

START POSITION: Standing behind rear entrance to Helicopter, arms folded across chest. Loaded Rifle is on floor of helicopter, buttstock on X, muzzle downrange. Bipods may be opened and extended.

STAGE PROCEDURE

At audible start retrieve rifle and engage all targets from fully within the helicopter.

SCORING

SCORING: Comstock, 10 rounds, 80 points
TARGETS: 4 IPSC, 6 Rifle Flashers
SCORED HITS: Best 1 per IPSC
 Steel hit is 2A
START-STOP: Audible - Last shot
PENALTIES: Procedural. -10
 No-shoot hit. -10
 Miss. -10 per paper, -20 per steel

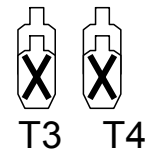
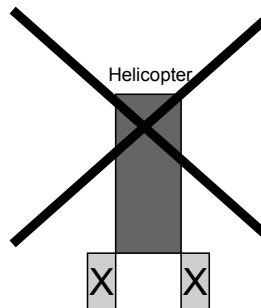
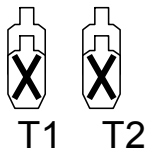
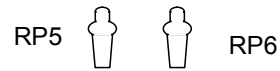
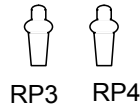

SETUP NOTES: Set Rifle Flashers at approx. 175 yards. Set paper targets at side berms

RO NOTES:

MOR Stage 3, Bay 12

“William Tell Ugly”

RULES: Practical Shooting Handbook, Latest Edition **COURSE DESIGNER:** Tom Chambers

START POSITION: Standing facing downrange with heels on rear fault line. Loaded Rifle is at port arms.

STAGE PROCEDURE

At audible start engage T1-T9 as they become visible from within the charge and fault lines.

SCORING

SCORING: Comstock, 9 rounds, 45 points
TARGETS: 9 IPSC
SCORED HITS: Best 1 per IPSC
START-STOP: Audible - Last shot
PENALTIES: Procedural. -10
 Miss. -10

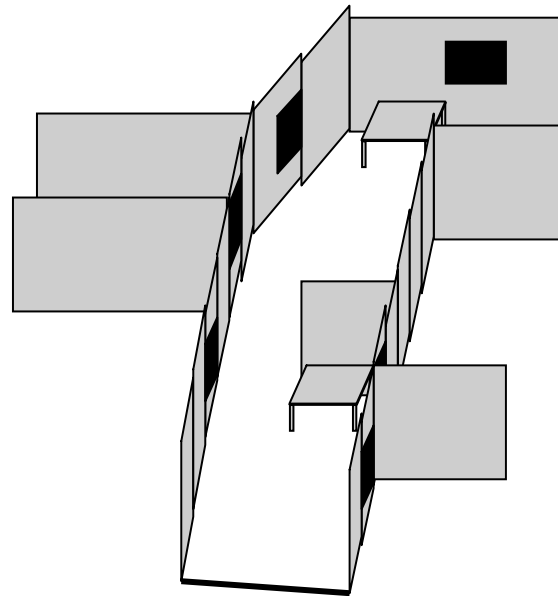
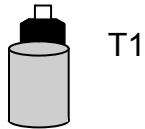
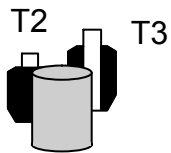
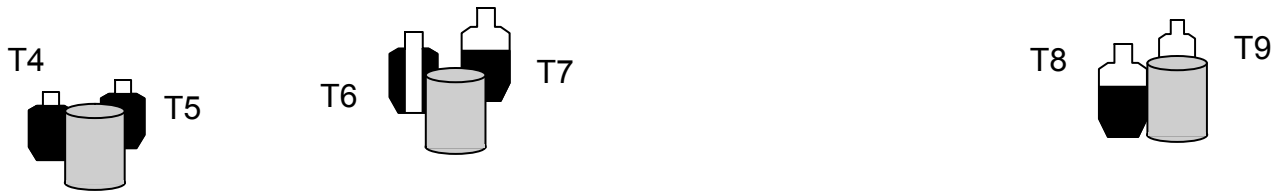

SETUP NOTES: Targets are against berm.

RO NOTES:

MOR Stage 4, Long Range Rifle Bay "As Far as It Gets"

RULES: Practical Shooting Handbook, Latest Edition **COURSE DESIGNER:** Tom Chambers

START POSITION: Standing with heels against marks, loaded rifle at port arms	
<p>STAGE PROCEDURE At audible start engage all targets as they become visible from behind the charge and fault lines.</p>	<p>SCORING SCORING: Comstock, 9 rounds, 90 points TARGETS: 9 Rifle Flash Targets SCORED HITS: Hit Steel is 2A START-STOP: Audible - Last shot PENALTIES: Procedural. -10 Miss. -20</p>

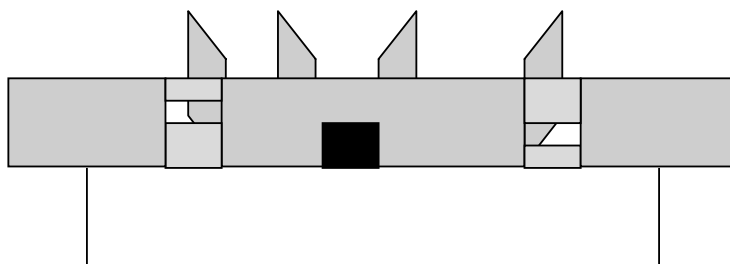
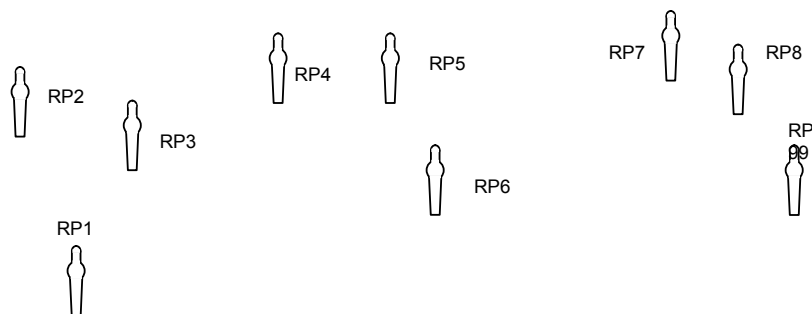

SETUP NOTES: Targets are between 300 and 450 yards	RO NOTES:
---	------------------

US APPENDIX D4**Manual Operated Rifle Open Division**

1	Minimum power factor for Major	320
2	Minimum power factor for Minor	150
3	Minimum bullet weight	No
4	Minimum cartridge case / bullet diameter	No
5	Minimum caliber for Major	No
6	Minimum trigger pull	No
7	Maximum firearm length	No
8	Maximum magazine length	No
9	Maximum ammunition capacity	Five rounds loaded maximum
10	Max. distance of mags/speed loaders from torso	No
11	Restriction on action type	Yes, Manual Action only
12	Restriction on position of holster and other equipment	No
13	Optical/electronic sights permitted	Yes
14	Compensators permitted	Yes
15	Ports permitted	Yes
16	The use of bipods and similar allowed	Yes
17	Modifications allowed	Yes
18	Factory produced guns only	No